

# OverDrive eBooks is now Sora

OverDrive eBooks will now be accessed through the Sora platform. Sora is available on a mobile device via an app or in a browser on a desktop/laptop computer. The books in the collection remain the same. Loans are still one-user-at-a-time, first-come-first-served basis. All users are limited to 8 loans at a time.

Download the app on your own personal device but use on the desktop/laptop version on a shared computer.

## App Version:

Download the Sora app from the appropriate App Store for your device.

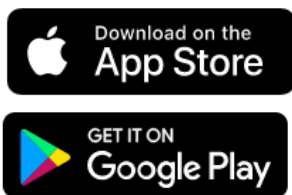

Click 'Find my school.' A few MVSD schools may be listed. If yours is not, click 'My School isn't listed.'

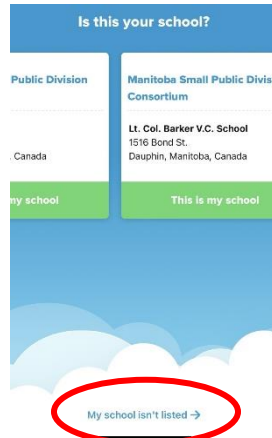
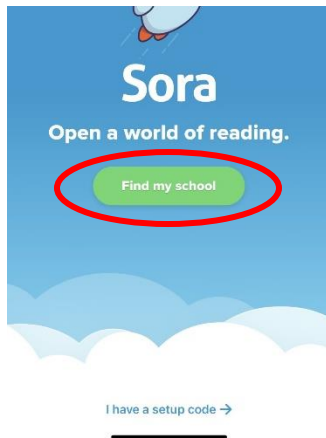

Type Manitoba and choose 'Manitoba Small Public Division Consortium.' Choose "Mountain View School Division" from the dropdown list.

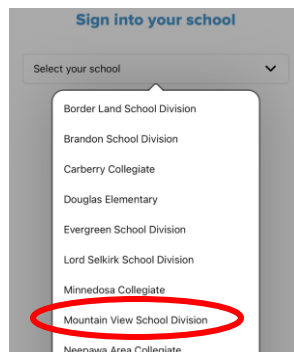
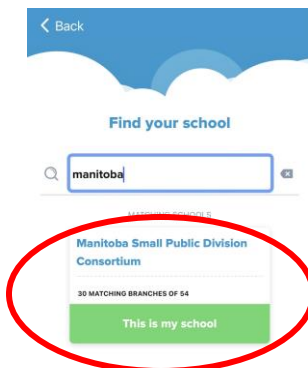

Enter your library card number (from your school librarian); your password is the last 4 digits of your library card number.

## Desktop/Laptop Computer:

To use Sora on a desktop/laptop computer, go to <https://soraapp.com/welcome/login/202404> or click the Library icon found at the bottom of the MVSD website or any MVSD school's website, which takes you to the MVSD Library page. Then click the Sora app icon.

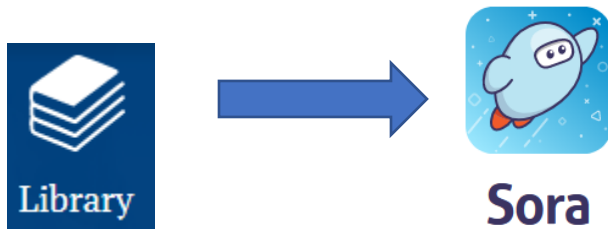

On the Sora website page, you will need to choose our account:

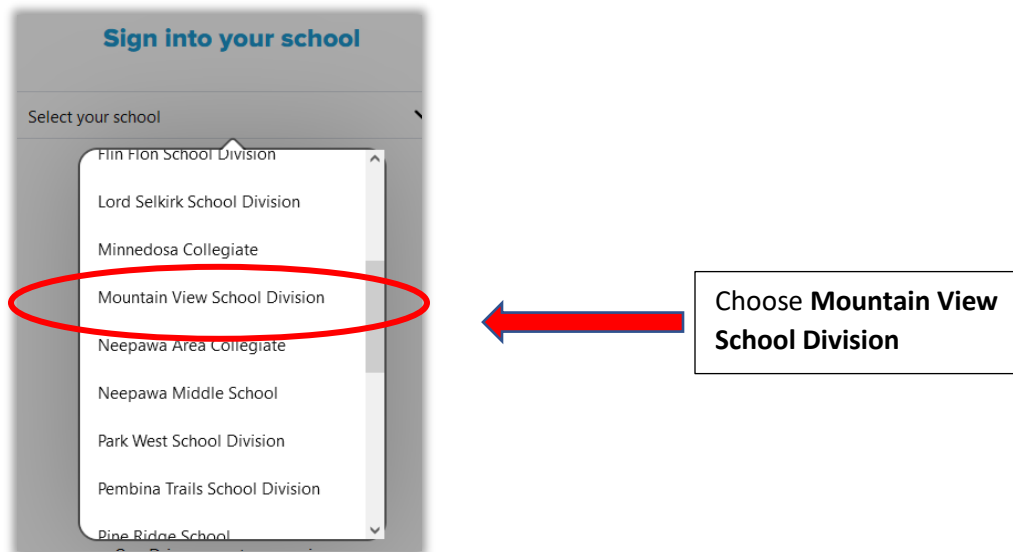

Enter your library card number and password. If you do not know your library card number, please check with your school Library Assistant. Your password will be the last 4 digits of your library card number (for users with 3-digit library card numbers, your password will be the same as your card number).

Mountain View School Division

Library Card

Your library card number

Password

Last 4 digits of your library card #

Sign in

## Navigating the Site:

From the menu at the bottom of the page you can search for books, access your current items, etc.

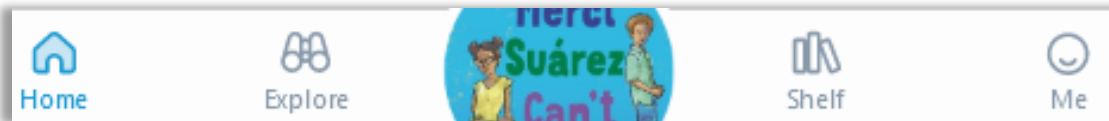

Home	Explore		Shelf	Me
Your account information: the books you have signed out, any notes you've made, etc.	Where to go to find books; search by subjects, theme-based lists, etc.	 <i>A link for the book you are currently reading will be in the centre.</i>	All of your current loans, holds, lists, and history.	Your reading statistics, plus some fun reading achievement badges.

## How to find something to read:

Click the Explore icon (binoculars) on the bottom menu. There are three ways to find books:

1. search by keyword
2. explore the various theme lists
3. check the Popular Subjects lists

Keyword: Type a title, author, or topic here

Theme lists: Click a cover or click All/ Over # books to see all in this set

Popular Subjects: the number shows how many titles are in the list

Explore

Search for a book

1 Preferences

Haunting & Humorous Horror  
Over 100 books >

Popular Subjects

2,485 Juvenile Fiction	1,762 Juvenile Literature	1,518 Young Adult Fiction	995 Young Adult Literature
784 Fantasy	691 Juvenile Nonfiction	593 Humor (Fiction)	584 Comic and Graphic Books

## Enhance your Reading Experience:

Click the 3-line menu icon in the upper right corner to change your settings. You can choose dyslexic font, or make your display high contrast. You can also choose your preferred lending period.

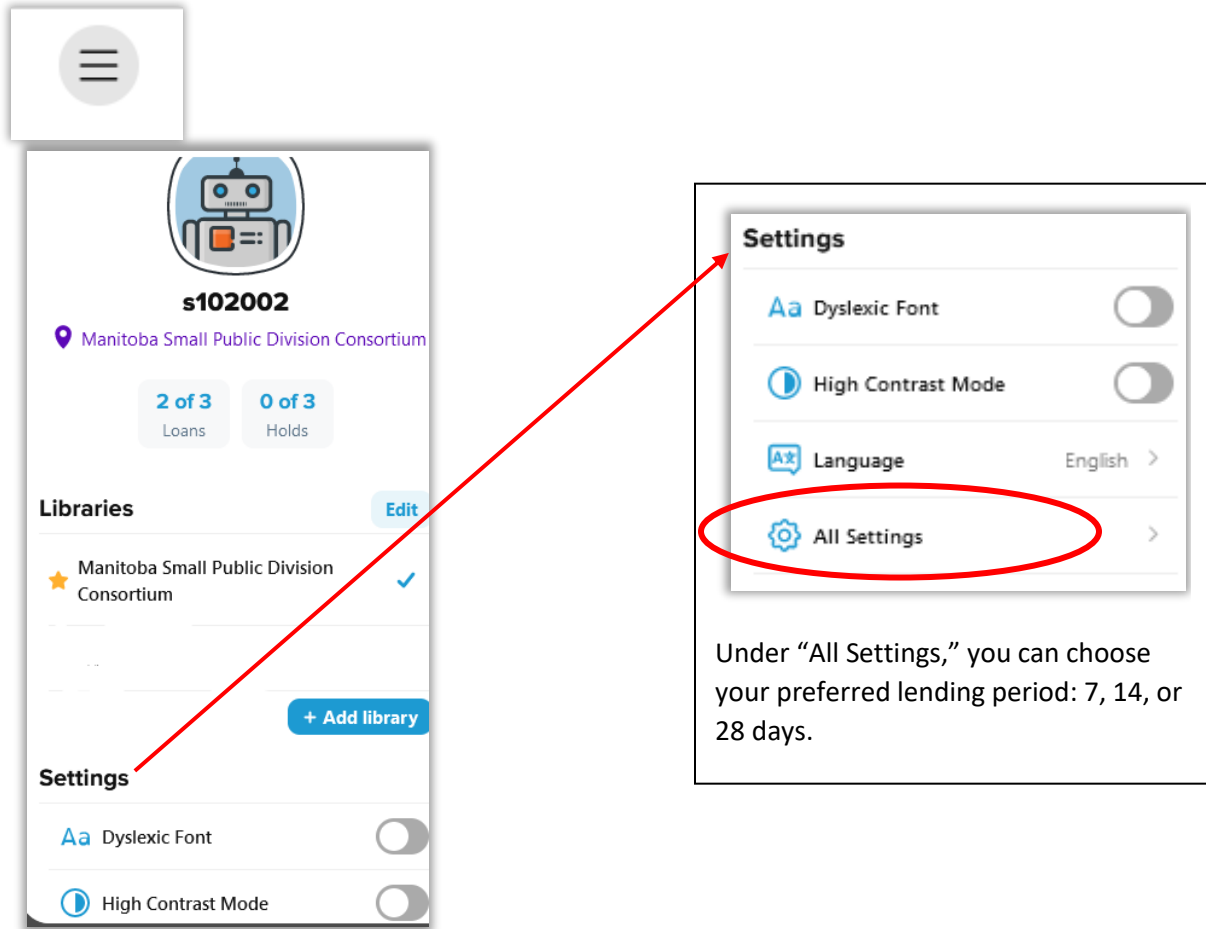

While you are reading a book you can make further changes or perform more tasks. Take a look at the icons in the upper right corner of the page while you are reading.

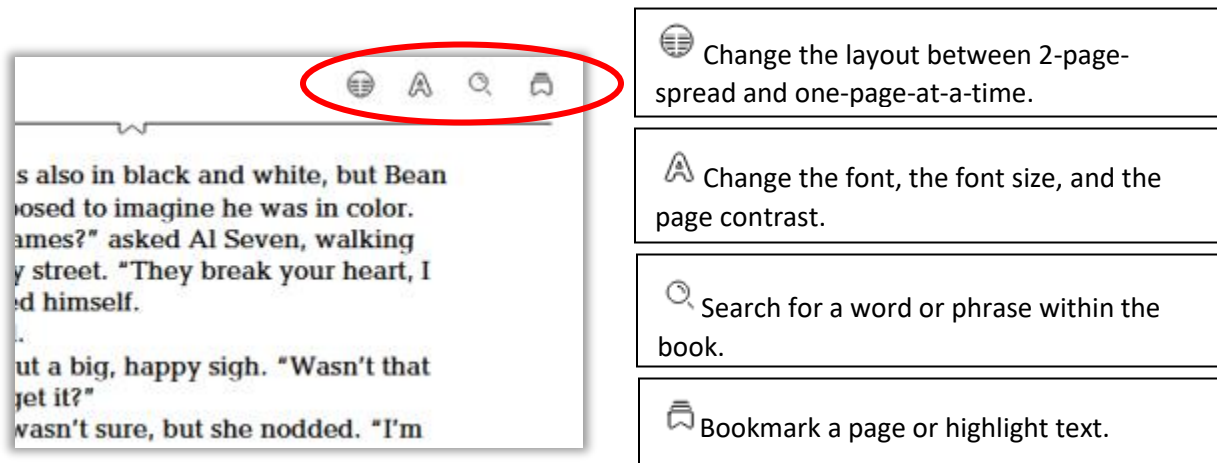

## Frequently Asked Questions

**Is it a Book or an Audiobook?** Books will be rectangular and say “Read sample;” audiobooks will have square covers, have a headphone icon underneath, and say “Listen to sample.”

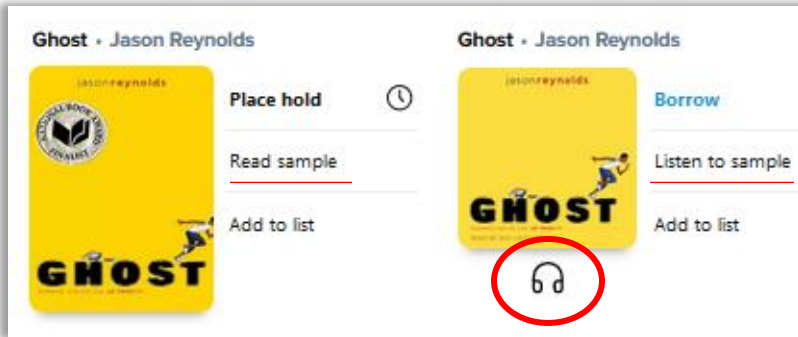

**Is the book available right now?** If it is available, it will say “Borrow” beside the cover. If it is not currently available, it will say “Place hold.”

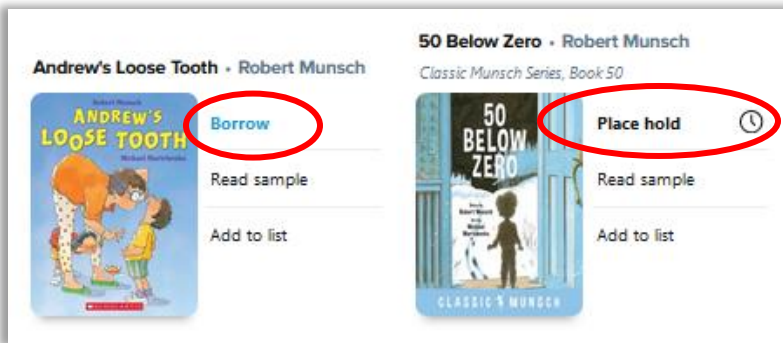

**If I place a hold, how long do I have to wait?** Click the cover to open the book record. Look below the cover picture for the estimated wait time. If someone returns the book early, you may get it earlier.

This image shows the book record for '50 Below Zero' by Robert Munsch. On the left, there is a table with book details:

FORMAT	Read-along ebook
LANGUAGE	English
SERIES	Classic Munsch
AUTHOR	Robert Munsch
ILLUSTRATOR	Michael Martchenko
AUDIENCE	Juvenile
LEVELS	Lexile® score: 380 Text difficulty: 1
COPIES	0 available, 1 total

Below the table is a description of the book and a 'Place hold' button. A red circle highlights the 'Place hold' button, and a red arrow points from it to a 'WAIT LIST' pop-up window. The pop-up window shows:

- 4 weeks
- 1 copy in use
- 1 person waiting

A speech bubble points to the 'about 4 weeks' wait time estimate at the bottom of the book record.

**How will I know when my hold is available?** When your hold is available, when you log in you will see a bell with a red dot in the upper right corner. When you click the bell, you will have the option to borrow the book now, or later on if you are not ready to read it at this time.

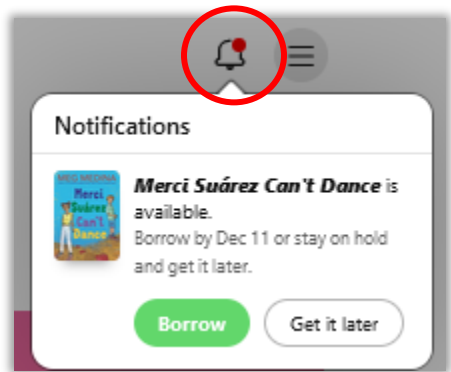

You will only have three days to check out your hold once it becomes available.

**Are there any picture books that read the book aloud?** Yes! They are called Read-along eBooks. If that option is available for a particular book it is listed as the format in the book record.

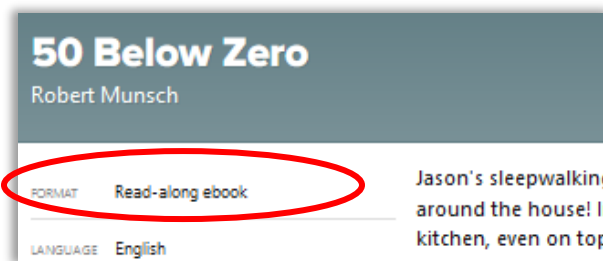

The narrator will read the book aloud and the text will be highlighted as you proceed.

**How do I find which books have the Read-along option?** To see all of the Read-along eBooks, click the Explore icon (binoculars); under the "Search for a book" box, click "More options" and then tick "Read-along eBooks" near the bottom of the list.

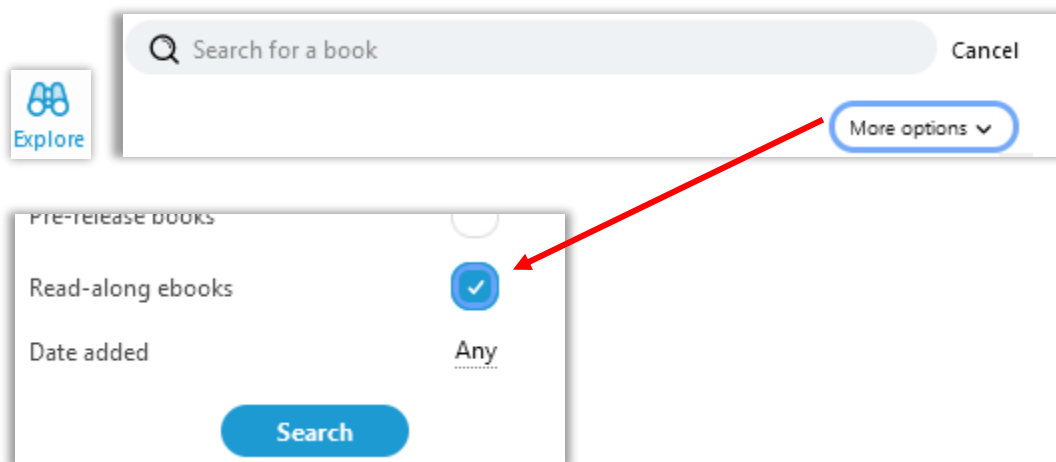

**Do all picture books have the Read-along option?** No. If it does not, the format will be listed as “Ebook,” not “Read-along eBook.”

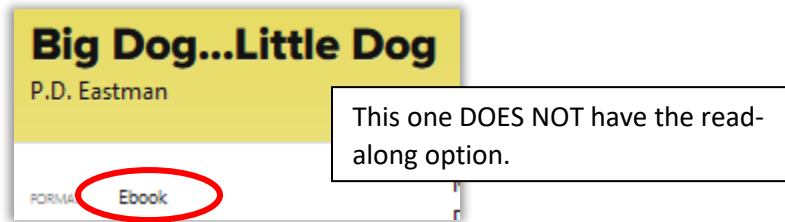

**How long do I get to borrow a book for?** You can set the loan length. Before you borrow an item, set your lending period for 7, 14 or 28 days (the default is 14 days). Click the three-line menu icon in the upper right corner; under Settings choose All Settings; under General choose Lending Periods; select your preferred loan length for eBooks and Audiobooks.

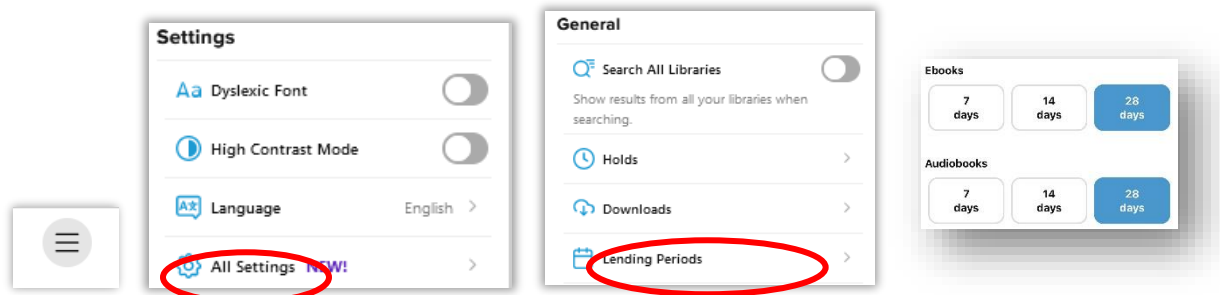

**Can I return a book early?** Yes! To return an item, click on the Shelf icon at the bottom of the page; click the cover of the item you want to return; click “Return”; click “Return” again on the next page.

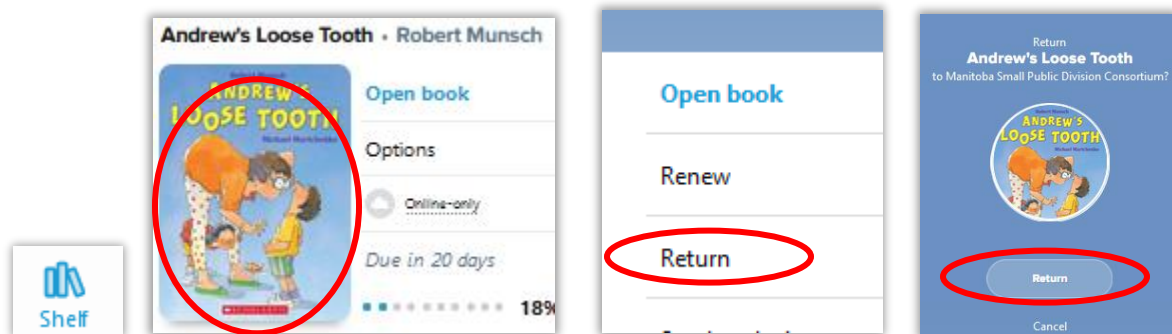

**Can I customize the age range or type of books I see when searching?** Yes! Click the Explore icon (binoculars) at the bottom of the page. Click the Preferences button in the upper right corner. To change the age-level-applicability of displayed book suggestions, click beside “Audience” and choose “Juvenile” or “Young adult.”

